

Miami Sun

Trike Assembly Manual



J&B Importers

Attach this coupon to your receipt and present both to dealer if service is required.

Owner's name _____

Address _____

City _____ State _____ Zip _____

Date purchased _____ Model no. _____ Serial no. _____

Dealer's name _____

Address _____

City _____ State _____ Zip _____

For customer's use

Miami Sun Limited Warranty

The Miami Sun frame, purchased from an authorized dealer is warranted to be free from defects in materials provided the trike is owned by the original buyer.

The original fork and rear unit is warranted to be free from defects for a period of 90 days from date of purchase. Shipping and labor charges are not included in the warranty. Tires, tubes, cables and brake shoes are excluded.

All warranty claims must be submitted with your bill of sale and serial number.

This limited warranty does not cover personal injuries, damage or failure due to accident, alteration, abuse, wear and tear, neglect, improper assembly or maintenance.

NOTICE: This limited warranty is void when the trike is used for rental, commerce, sold, given away, modified, used for stunts, ridden off road, or if a motor or other power driven device is installed on the trike.

See your authorized *Miami Sun* dealer for service and replacement.

PLEASE READ THIS MANUAL BEFORE RIDING YOUR ADULT TRIKE

This manual is intended for you to read carefully so that you may enjoy your adult three wheeler and be an informed rider aware of the benefits as well as the warnings and safety issues in riding this tricycle.

A trike is not a bicycle and this manual contains specific information and warnings that will let you enjoy your Miami Sun in comfort and safety.

Tricycling is a sport and a mode of transportation. With it comes the risk of an accident that could result in injury and even death. By riding this trike you assume that risk.

We want to give you as much information as possible to make you a safer rider. We cannot cover all contingencies but we can make you more aware and informed.

Municipal bicycle regulations also apply to tricycles. Most states and municipalities have bike regulations. It's up to you to research those regulations and become informed. Your dealer may be able to help you with this information.

Since you will be sharing the road at times with other vehicles a good rule to follow is "If you can't do it with a bicycle, don't do it with a trike."

A trike's widest point is behind you, if the front goes by an obstacle there is no guarantee that the rear wheels will also clear. When riding, you must give clearance to the edge of the road or sidewalk. Stay clear of potholes and be aware that you can lose control if any wheels should drop into a hole.

Always ride defensive. Watch out for the unexpected. This means everything from cars to children, pets and rough road surfaces. Be prepared to avoid danger.

ALWAYS WEAR A BICYCLE HELMET. We recommend buying your helmet from a dealer that can fit and instruct you on the correct way to wear this helmet.

Protecting your head is your primary safety responsibility.

Always wear a CPSC, ANZI, ASTM, or SNELL approved bicycle helmet. CPSC is the new federal standard and all helmets must comply by 1999.

CHECKLIST BEFORE RIDING

1. Check your tires for proper air pressure. If you need to inflate them do not inflate over the recommended air pressure on the side wall.
2. Test your front brake and make sure it stops the trike. If you have any doubts do not ride and see your dealer. All trikes are equipped with a front brake as standard equipment and primary stopping system. This also applies to a trike that may have the coaster brake option. Under no circumstance should the front brake be removed.
3. Check that the handlebar is tight and that the ends are plugged. Now check the saddle for tightness.
4. Move the trike forward and back. If you hear or feel any resistance, do not ride.

If you feel that something is not right after performing your check **DO NOT RIDE**. Take your trike to your dealer.

PRECAUTIONS

- A trike does not handle like a bicycle, therefore, you cannot lean into a turn. All wheels must be on the ground at all times. Do not make sudden changes of direction you could unbalance the trike and have an accident.
- When beginning to ride, stay at a slow speed. You must acclimate yourself to handling and turning this three wheeler. If you feel insecure, slow down, and proceed at a slower pace. With practice, you will get comfortable riding and stopping.
- We recommend that you not ride at night, or at times of reduced visibility. If you should ride at night or during reduced visibility, you must outfit your trike with a front white light and a rear red light . Relying solely on reflectors is not adequate protection. Most municipalities require lights for night riding. Your bicycle dealer can help you in selecting the correct lighting system for your needs.
- The rear basket is only intended for light storage. **DO NOT EVER PUT A CHILD OR PET IN THE BASKET!** They could be seriously injured by the turning wheel and/or the moving parts. There is also the risk of the passenger falling out of the basket. The trike is made for one person only and the basket is not built to hold a passenger.
- **Weight capacity is 250 lbs. This trike is built for manual use.**

"Miami Sun"

Parts Description

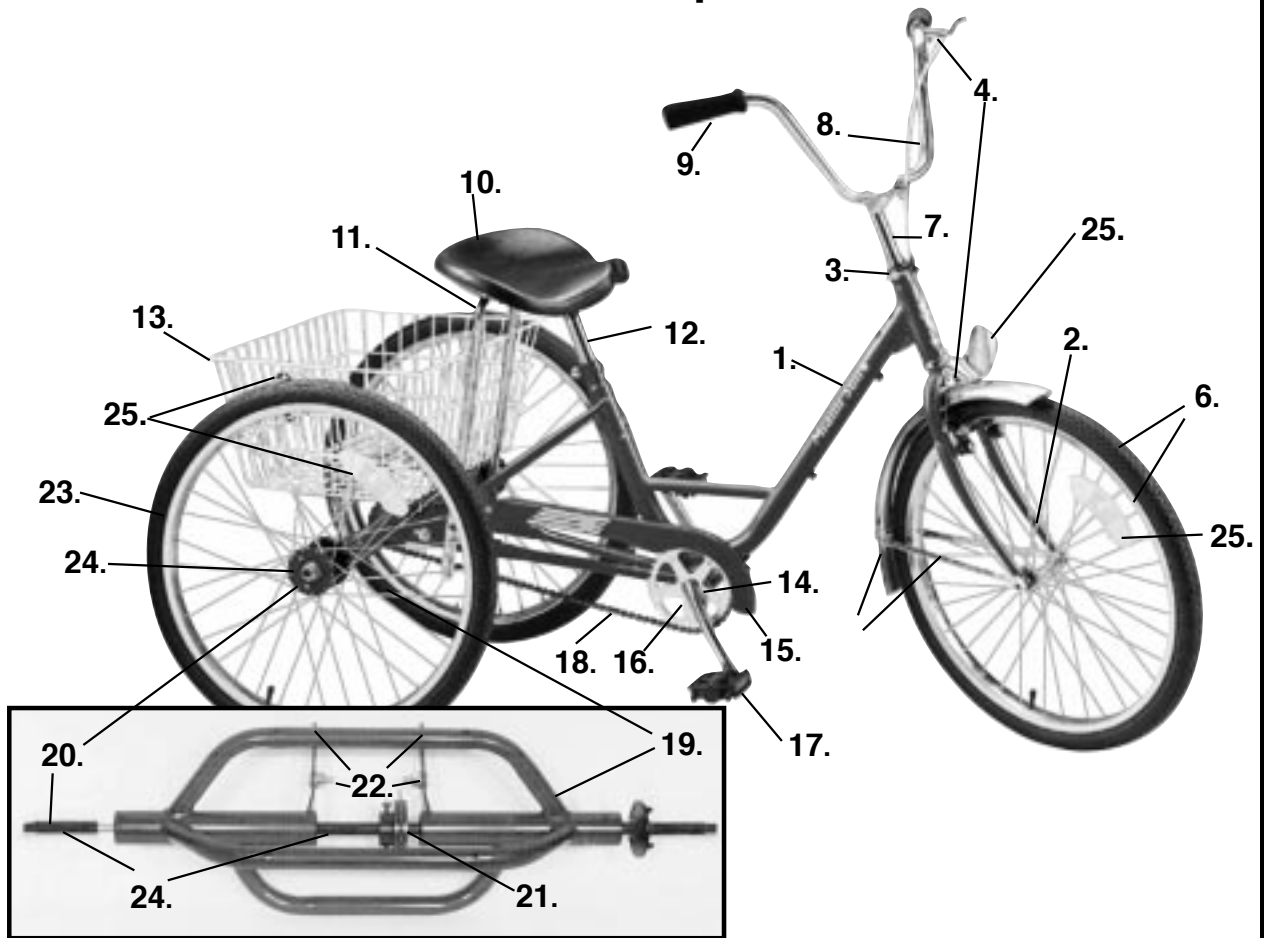

Miami Sun

Parts List and Description

- | | |
|--|--|
| 1. Frame | 15. Chainguard |
| 2. Fork | 16. One Piece Crank 6"x1/2" with Chainring 36T |
| 3. Headset | 17. Pedals 1/2" |
| 4. Front Cantilever Brake w/ Locking Lever | 18. Chain 1/2" X 1/8" X 110L |
| 5. Front Fender with Braces | 19. Rear Unit |
| 6. Front Wheel, Tire, Tube 24 X 1.75 | 20. Rear Axle with Nuts |
| 7. Stem | 21. Freewheel 20T, Adapter with Set Screws, Axle Key |
| 8. Handlebar | 22. Two Large Bolts, Two Small Bolts with nuts & washers |
| 9. Grips | 23. Two Idler Wheels, 24X1.75, Tire, Tube |
| 10. Western Saddle with Clips | 24. Bearings |
| 11. Seat Brace | 25. Reflectors |
| 12. Seat Post | |
| 13. Trike Basket with Fittings | |
| 14. Bottom Bracket Set | |

"Miami Sun"

Trike Parts List & Description



- | | | | | | |
|------|---------|------------------------------------|------|---------|--------------------------------------|
| (1) | 670262 | Miami Sun frame blue | (13) | 6702180 | Basket trike white vinyl coated |
| (1) | 670260 | Miami Sun frame red | | 6702181 | Basket fittings |
| (1) | 670261 | Atlas frame yellow | (16) | 6702067 | Crank one piece 6" |
| (2) | 6702291 | Fork w/pivots chrome 24" | (14) | 22240 | B.B. OPC set 24 TPI |
| (3) | 35002 | Headset 30.0 X 27.0 | (16) | 6702068 | Chainring 1/2X1/8"X36T |
| (4) | 6702290 | Brake set Canti w/locking lever | (15) | 6702295 | Chainguard CP hockey stick style OPC |
| | 6702145 | Brake lever w/lock | | 6702172 | Chainguard CP full round style OPC |
| | 6702146 | Brake cable 890 X 760 mm Blk. Frt. | (18) | 1603 | Chain 1/2 X 1/8 112L |
| | 13395 | Brake shoe canti white | | 6702171 | Chain 1/2 X 1/8 50L for conversion |
| (5) | 6702155 | Fender front 24" S.S. w/braces | (17) | 41118 | Pedal 1/2 |
| | 6702158 | Fender brace rear 24" | (19) | 6702218 | Rear unit housing Blk. for 15mm |
| | 6702160 | Fender rear 24" set w/braces S.S. | (22) | 6702210 | Rear unit hardware 4pc set |
| | 6702161 | Fender rear 26" set w/braces | (20) | 6702191 | Rear axle 15mm |
| (7) | 57380 | Stem 6" X .875 | | 6702192 | Rear axle washer R.H. |
| (8) | 3330 | Handlebar hi-rise Wald # 870 | | 6702193 | Rear axle spacer Idler side L.H. |
| (9) | 3109 | Grips 7/8 Black | (24) | 6702184 | Bearing 15mm |
| (12) | 6702175 | Seat post chrome 28.6mm | (21) | 6702199 | FW adapter 15mm w/2 screws |
| (10) | 6702130 | Saddle Western USA | (21) | 6702201 | Screw for adapter |
| (10) | 6702132 | Saddle Western Imported | (21) | 18350 | Freewheel 20T |
| (11) | 6702135 | Saddle support bar | | 6702203 | Axle key for 15mm axle |
| | 6702140 | Saddle hardware western | | 6702204 | Axle nut for 15mm axle |
| | 4935 | Saddle industrial trike | | | |

"Miami Sun"

Trike Assembly Instructions*



(Fig. 1)

Step 1) Steering Head Adjustment

- A. Place trike in an upright position on floor, loosen head lock nut and the adjusting cone.
- B. Re-tighten adjusting cone finger-tight. Turn the fork from side to side. Fork should turn with no rocking or free play.
- C. Securely tighten head locking nut down onto washer.

Step 2) Front Wheel Alignment & Attachment

- A. Place fender braces on each side of axle.
- B. Check to make sure front wheel is centered in fork. If it is not, align wheel to center of fork and retighten securely.

*** Assembly to be done by qualified bicycle mechanic**

Step 2) Cont'd

C. Make sure that safety fork washer devices remain hooked into fork end tips.

D. **“Warning:**

Do not ride without safety fork washers.”



(Fig. 3)

Step 3) Free Wheel Rear Unit Assembly

A. Thread the free wheel adapter into the plain side of free wheel and tighten until free wheel and adapter are flush with each other. (Fig. 4A)

**At this time we recommend spraying the axle with a dry Teflon lubricant for improved performance **

(Fig. 4A)

B. Pull unit axle halfway through unit, install adapter with free wheel, making sure that free wheel faces axle flange. Now push axle all the way through the unit.

C. Study Fig. 4B for correct positioning of components on unit.

D. Unit is now ready to be installed on trike frame.



Note: Do not install axle key yet.

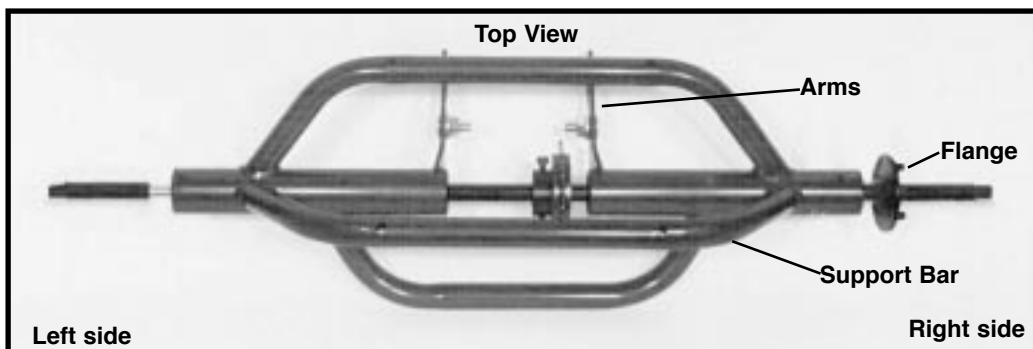

(Fig. 4B)

Step 4) Attaching Free Wheel Rear Unit To Frame

Installing unit to frame is a simple matter of attaching two pairs of long and short carriage bolts. Please proceed in the following sequence:

A. Install loosely the two large carriage bolts with their nuts and washers, to the two holes in the end of the trike frame stay. The heads of the bolts are on the inside of the frame.

B. Slide the arms of assembled unit between rear frame stays, up to and between large carriage bolt heads and frame slot. Finger tighten nuts.

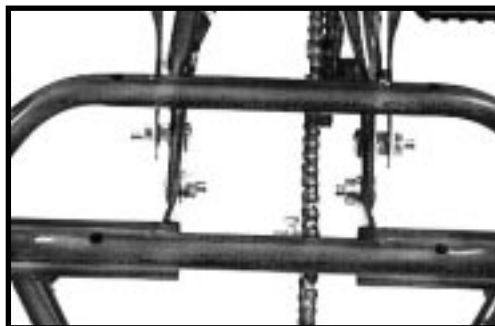

(Fig. 5)

C. Align the first most forward holes on unit arms with rear frame slot. Attach the two smaller carriage bolts and finger tighten. Note that the heads are outside the frame. (Fig. 5)

D. Make sure that axle flange on unit is to the right side of unit and frame. Also unit must be installed with support bars up, so that the basket can rest on them.

Step 5) Chain Installation & Adjustment of F.W. Unit

A. Unsnap chain, thread chain around chainwheel and freewheel. Reconnect chain with two-piece connecting link.

B. Slowly pull unit towards end of trike until chain slack is taken up.

C. Tighten the two small carriage bolts.

D. Turn chainwheel and see if chain runs smoothly with no binding or excessive noise. if not, loosen bolts, move unit slightly forward. Tighten bolts and check chain function again.

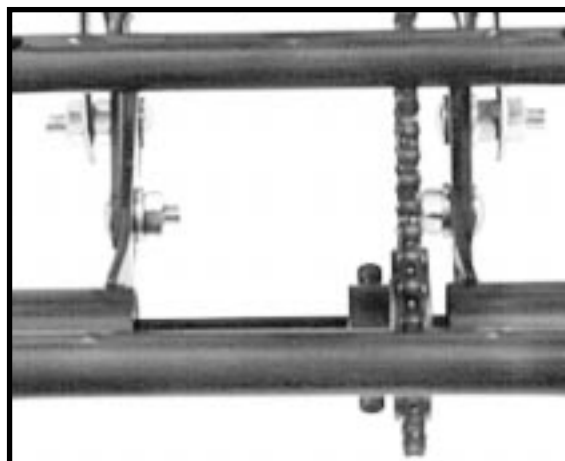

(Fig. 6)

E. Make sure the chain runs straight and true with the chainwheel.

F. If chain now runs O.K. tighten all four carriage bolts securely, taking care that the unit does not shift.

G. Now install chainguard.

Note: Large bolts will hold seat brace in Step 10

Step 6) Attaching Pedals

- A. Each pedal axle is marked with "R" (right) or "L" (left). Install them in their correct position. Note that the left pedal tightens by turning counter clockwise and that the right tightens clockwise. The right side is the chain wheel side.



(Fig. 7)

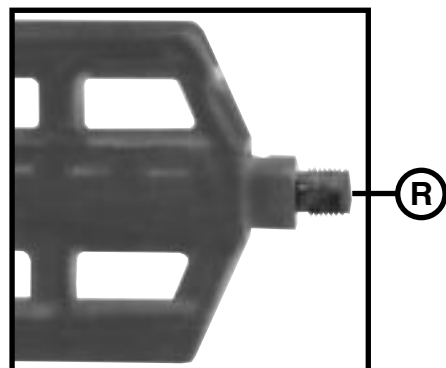

Step 7) Axle Key Installation

- A. Align axle slot with adapter slot.
Tap key into slot.
- B. Check the following:
1. Axle flange is flush against unit outer bearing.
 2. Freewheel is all the way to the right and lined up with front chainwheel so that the chain is straight. (Check FIG.6)
 3. Now tighten set screws on adapter securely.

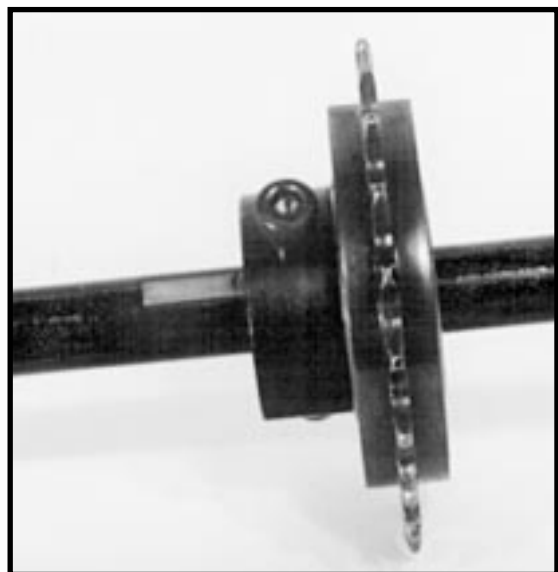

(Fig.8)

Step 8) Attaching Rear Wheels

- A. Both wheels are the same. The hub flanges have three holes that fit the studs on the axle flange. Install the drive wheel first, (right side). Add axle washer on the outside and snug down locking nut. **Over-tightening will damage the bearings.**

Step 8) Cont'd

- B. Now put the second wheel on left side . This wheel is the idler. First slip on the spacer, then the wheel, followed by a washer and the locking nut until it touches the bearing. **Again Do Not Over Tighten. Leave Some Play.**
- C. **VERY IMPORTANT:** It is critical for the protection of the bearings, that you inform your customer that the idler wheel requires a slight amount of play in order to prevent bearing damage.



(Fig.9)

Step 9) Western Seat Assembly & Installation

- A. Place seat upside down. Clip on the two seat brace clips to seat brace. Remove two nuts from studs in back of seat and attach brace to seat. Tighten nuts. (Facing Forward: Brace should be in front of studs).
- B. Reposition seat post clamp so that seat post is toward middle. **(Note fig, 10)** Place seat post on seat and tighten seat post clamp snugly.
- C. Place seat post into seat tube of trike. Put the middle holes on the seat brace into the two long carriage bolts. Attach nuts.



(Fig.10)

- D. Turn chainwheel and see if chain runs smoothly with no binding or excessive noise. If not, loosen bolts, move unit slightly forward. Tighten bolts and check chain function again.
- E. If chain now runs O.K. tighten all four carriage bolts securely, taking care that the unit does not shift.
- F. **“Warning: The seat post minimum insert mark must be inside the seat tube.”**

Step 10) Attaching Vinyl Basket

- A. With the reflector bracket on basket facing rear, place and center the basket onto the unit basket support bars.
- B. Align the two holes of unit basket support bar with the holes of the basket attaching brace. Attach nuts and bolts and finger tighten. Repeat for other bar.
- C. Tighten securely, all nuts and bolts.
- D. **Warning: Never put a child or pet in the basket.**

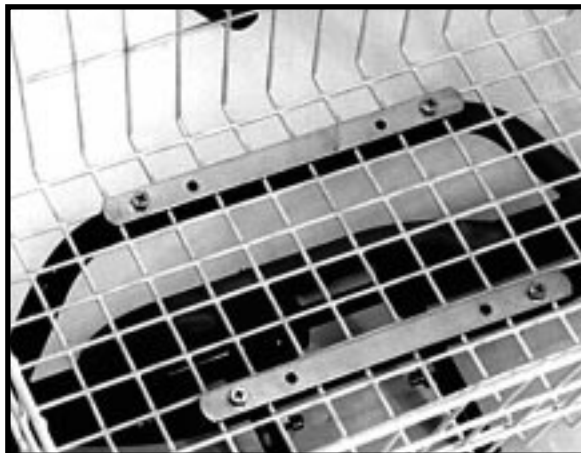

(Fig.11)

Step 11) Attaching Stem & Handlebar

- A. Loosen bolt on stem and insert stem into head tube.
- B. Insert handlebar through stem, center it and adjust to desired angle. Tighten handlebar binder nut securely.
- C. Place handlebar and stem at right angle to length of trike and tighten stem expander bolt securely.
- D. **“Warning: The stem minimum insert mark must be inside the head tube.”**



Step 12) Attaching Grips & Brake Lever

- A. Loosen screw on brake lever attachment bracket until lever slides over right handle of handlebar. Do not tighten screw yet.
- B. Slide grips on handlebar, making sure that grips are all the way to the end of the handlebar. **Do not use any type of lubricant to install grips.**
- C. Slide lever back, as close as possible, to grip on handlebar. Turn lever to desired angle and tighten securely.

Step 13) Attaching Reflector Kit

The white reflector is bolted to reflector bracket on fork. The red reflector is bolted to reflector bracket on rear of basket. The wheel reflectors are installed opposite valve stems on rims. For mag wheel the reflectors are installed on wheel tabs.

Step 14) Installation of Cantilever Brakes

- A. Install brake arms by inserting the end of the spring into the middle hole on the fork stud, tighten arm.
- B. Insert the cable end-nipple into slot on brake lever.
- C. Insert the cable into the cable hanger and tighten nut.
- D. Set link wire end-fitting into hook side of brake arch. Install the cable through the link wire housing and fixing bolt.
- E. Push both brake arches toward the rim, allowing 3 mm. clearance between brake shoes and rim. Tighten the wire fixing nut.
- F. Cut off excess cable, leaving about 25 mm. Put protective cap on cable end and crimp with pliers.



(Fig. 2)

- G. **“Warning: Removal of the front reflector bracket could result in serious injury if the brake cable snaps and the link wire snags the front tire.”**

Step 15) Check Tire Inflation

Check tires for 35 lb. of air and inflate as needed.

(IT IS ADVISABLE THAT ALL NUTS & BOLTS BE CHECKED FOR TIGHTNESS & SECURITY)

Trike Coaster Brake & 3-Speed Coaster Brake Conversion Instruction (Optional)

Step 1-A)

Prepare CB hub unit by attaching sprocket with concave side facing outward from hub. Concave sprocket faces in for the 3-spd. C.B.

Step 2-A)

Slide spacing washers on to axle on brake arm side of CB unit. No washers are used on 3-spd. C.B. hub unit.

Helpful Hint:

The trike CB & 3-spd. C.B. hub units are adjusted & aligned the same way as you would a CB wheel on an ordinary bike.

Note: When installing a coaster brake or 3-spd. coaster brake, you must substitute the fixed sprocket for the free wheel.

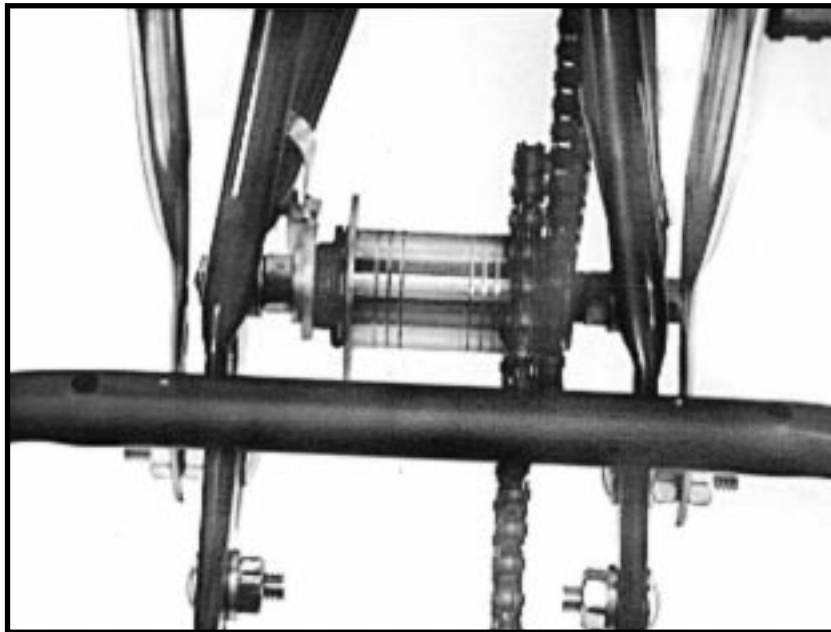

(Fig. 13)

Step 3-A)

Place CB or 3-spd. C.B. hub unit into special frame conversion slot brackets located on top of rear bottom frame stays, attach nuts. (Fig.14)

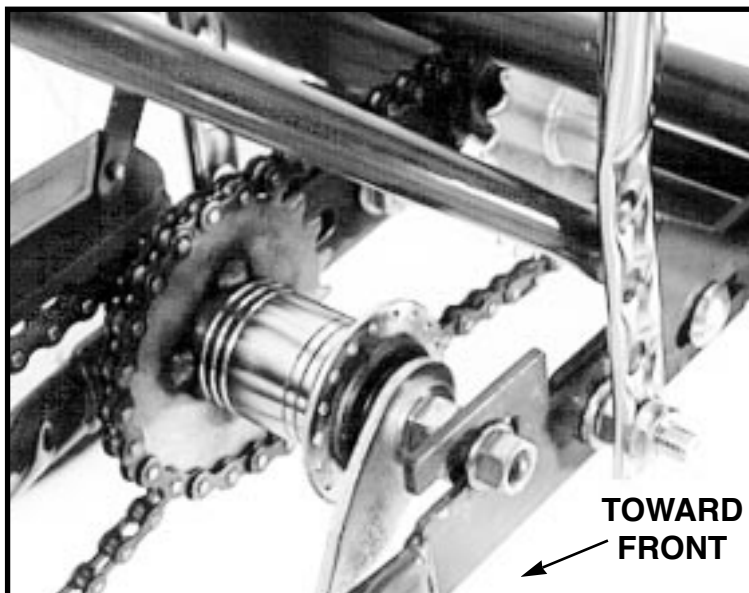

(Fig. 14)

Step 4-A)

Attach chain (84 Links) to chainwheel and outer CB or 3-spd. C.B. sprocket and connect connecting link.

Step 6-A)

Turn chainwheel and note chain condition, chain must run smoothly with no binding or excessive noise. If not, loosen nuts and readjust unit. If O.K., tighten nuts securely and attach brake strap to bottom left stay.

Step 5-A)

Pull hub towards rear to remove slack in chain, align unit at a right angle to frame, lightly tighten nuts.

Step 7-A)

Attach fixed sprocket onto rear trike axle. See **Fig. 4B** (pg. 9) and **step 8** (pg. 11)

You are now ready to attach unit to trike.

Installing unit to frame is a simple matter of attaching two pairs of long & short carriage bolts. Proceed in the following sequence:

Step 8-A) (Same as step 5)

1. Install loosely the two large carriage bolts with their nuts & washers, to the two holes in the end of the trike frame stay. The heads of the bolts are on the inside of the frame.
2. Slide the legs of assembled unit between rear frame stays, up to and between carriage bolt heads and frame slot. Tighten nuts.

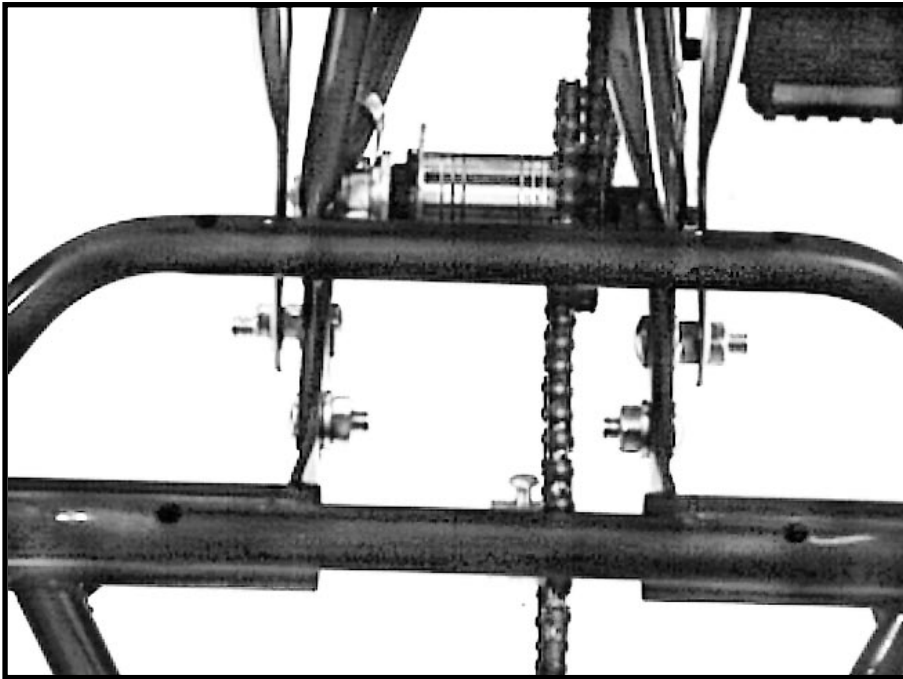

(Fig. 15)

3. Align the first most forward holes on unit legs with rear frame slot. Attach the two smaller carriage bolts and finger tighten. Note that the heads are outside the frame.
4. Make sure that the axle flange on unit is to the right side of unit & frame. Also unit must be installed with support bars up so that the basket can rest on them.

Note: Refer to general assembly instruction Pg. 7 through 13

Step 9-A) Chain Installation & Adjustment

1. Thread small 50 Link chain over CB or 3-spd. C.B. welded sprocket and unit fixed sprocket. Connect the connecting link, align both sprockets, install axle key and tighten set screw.
2. Slowly pull unit towards end of trike until chain slack is taken up.
3. Tighten the two small carriage bolts.
4. Turn chainwheel and see if chain runs smoothly with no binding or excessive noise. If not, loosen bolts, move unit slightly forward. Tighten bolts and check chain function again.
5. If chain now runs O.K. tighten all four carriage bolts securely, taking care that the unit does not shift.
6. Proceed to Step 9 on Page 11.